

Part new build and part refurbishment of Neale Wade Community College, Cambridgeshire

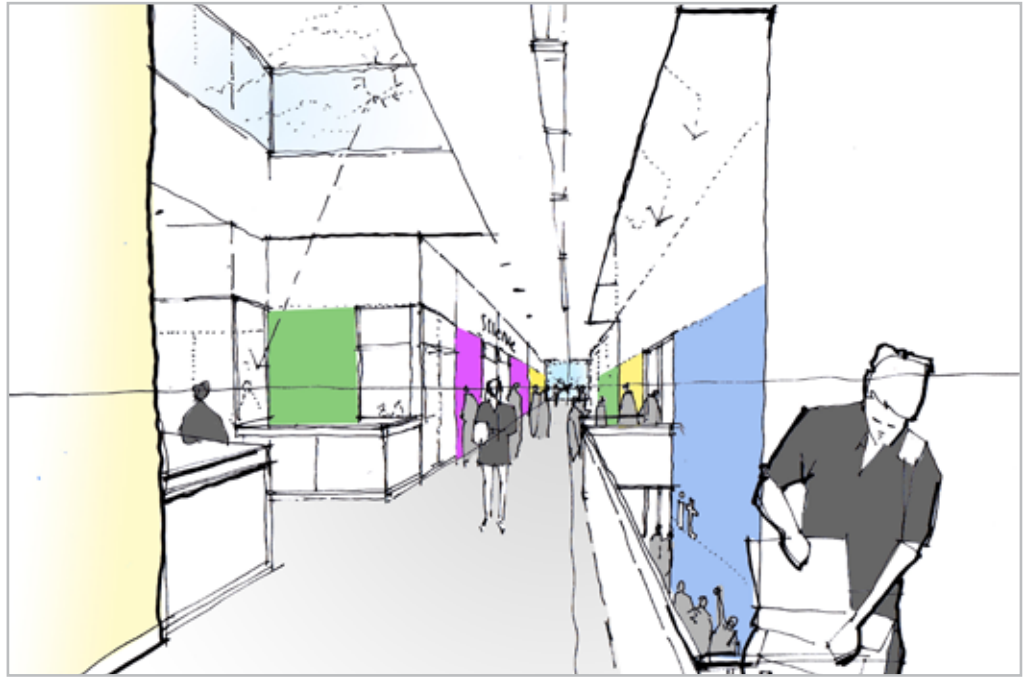
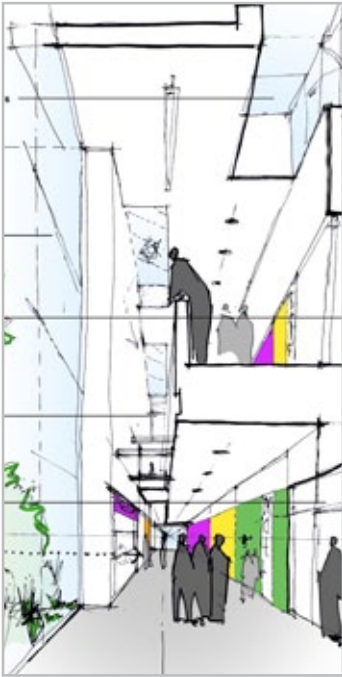

Client

Cambridgeshire
County Council

MLM Services

Building Control

Architect

RH Partnership

Contractor

Galliford Try

Contract Value

£23m

This project involves the phased demolition of parts of the existing school to make way for a 60% new build scheme, the remainder of the school being totally re-modelled and refurbished.

The client brief was to transform the institutional style campus buildings into one large linked building with open spaces for students to meet and use their laptops for research.

MLM played an important role within the design team to offer advice on all aspects of the project, including fire safety issues arising from the public areas open to the community out of school hours.

MLM

www.mlm.uk.com